

InFocus Projector Setup Guide for a DVD Player

How to connect a DVD player to an InFocus projector

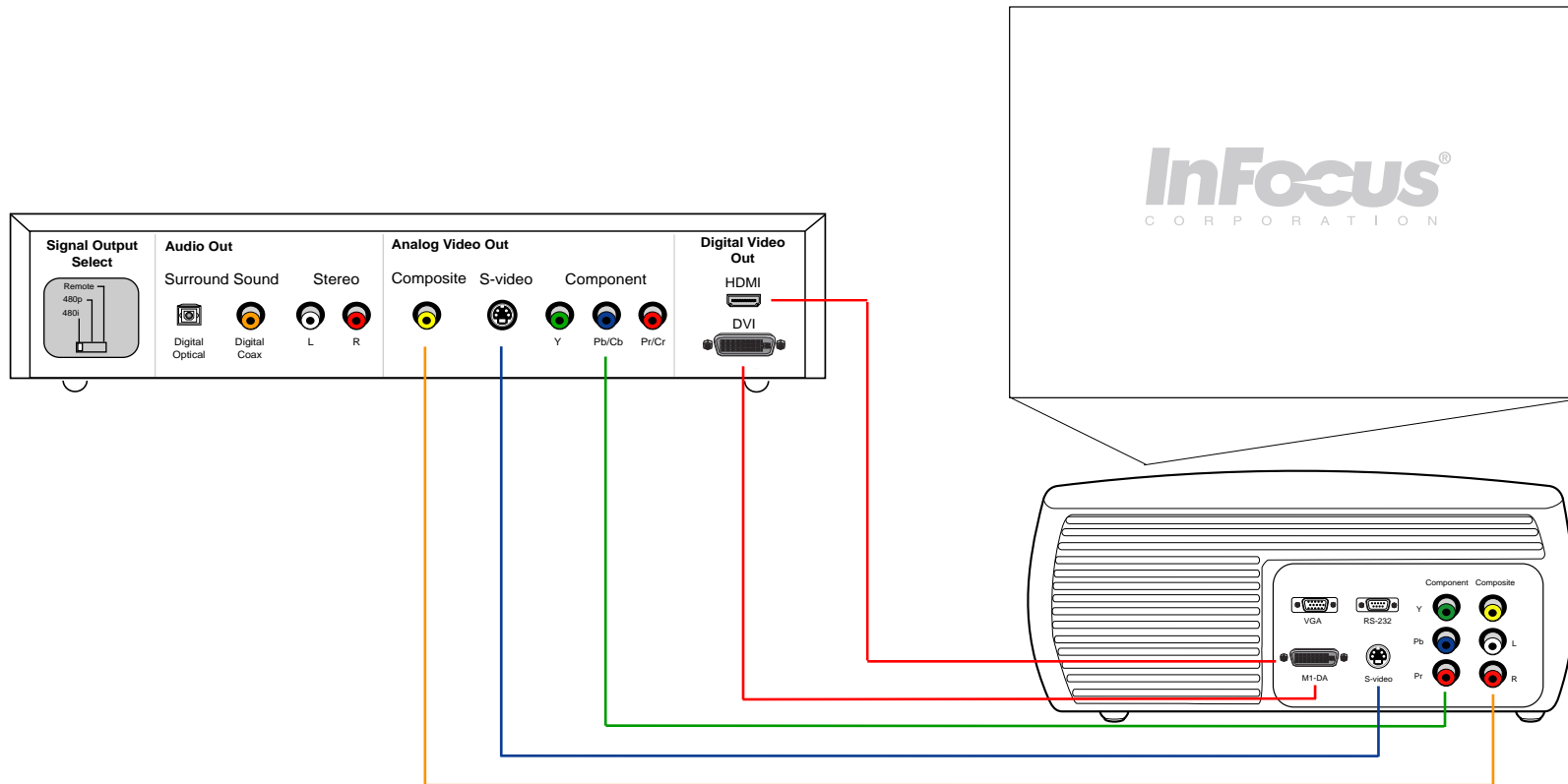

Table of Contents

- Good** - For the quickest setup, see [page 2](#).
- Better** - If you have an S-video port on your DVD player and projector, see [page 3](#).
- Best** - If you have component ports on your DVD player, see [pages 4-5](#).
- Premium** - If you have a DVI or HDMI port on your DVD player and M1 port on your projector, see [pages 6-7](#).

For more information and troubleshooting...

Read the tips, common issues and frequently asked questions on [pages 8-10](#).



Setup Requirements

- DVD Player with composite video-out port
- Projector with composite video-in port
- RCA composite video and audio cable (yellow, red and white male RCA)

1

Plug the RCA video connector into the composite port on your DVD player.

2

Connect the other end of the cable to the composite port on the projector. Connect audio connectors to the projector or an audio receiver.

3

Power on the projector, then the DVD player. Insert your DVD. You are ready to watch a movie!

DVD Player Connector Panel

connector panel may vary from actual product

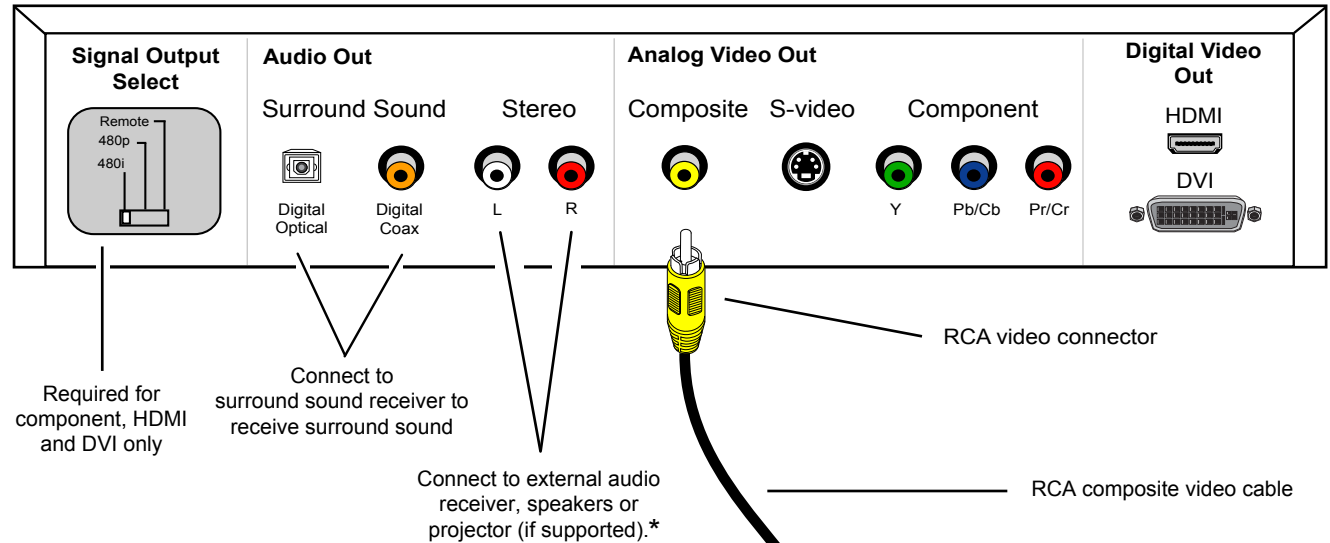

Projector Connector Panel

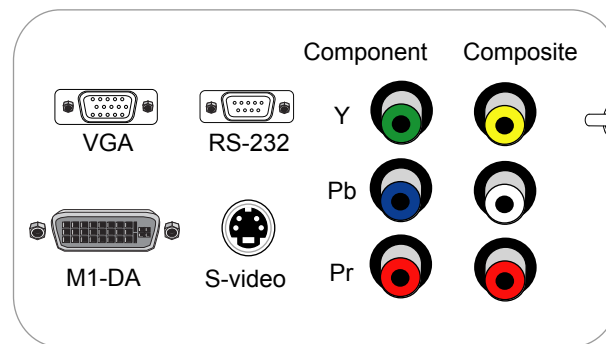

* We recommend connecting your DVD player to an external sound system to provide the best audio experience.



Setup Requirements

- DVD Player with component video-out ports
- Projector with component video-in ports
- Component video cable (red, green, blue male RCA)

1

Plug the color-coded component connectors to the corresponding ports on the DVD player.

2

Connect the other end of the cable to the component video ports on your projector.

3

Power on the projector, then the DVD player. Insert your DVD. You are ready to watch a movie!

DVD Player Connector Panel

connector panel may vary from actual product

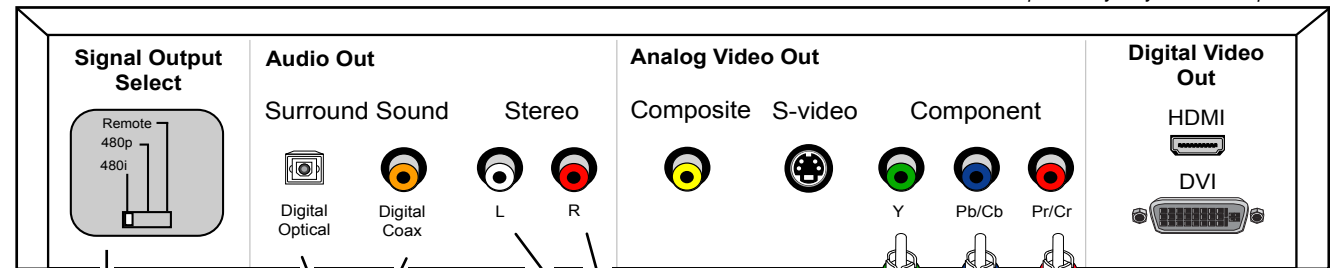

Required for component, HDMI and DVI only

Connect to surround sound receiver to receive surround sound

Connect to external audio receiver, speakers or projector (if supported).*

Projector Connector Panel

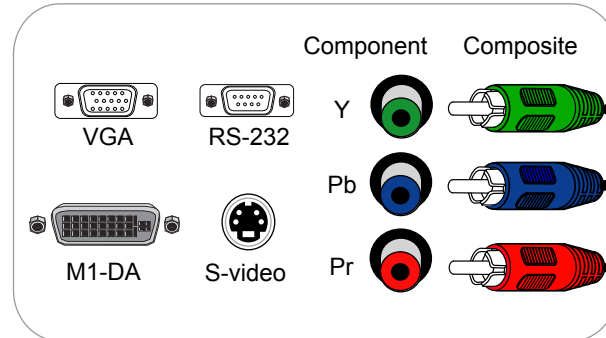

connector panel may vary from actual product

Component video cable (optional accessory)

* We recommend connecting your DVD player to an external sound system to provide the best audio experience.

Setup Requirements

- DVD Player with component video-out connectors
- Projector without component video-in connectors
- M1 to component adapter (InFocus part#SP-M1-ADPT)
- Component video cable (red, green, blue male RCA)



1

Plug the color-coded component connectors to the corresponding ports on the DVD player.

2

Connect the other end of the cable to the M1 to component adapter. Connect M1 adapter to the M1-DA port on your projector.

3

Power on the projector, then the DVD player. Insert your DVD. You are ready to watch a movie!

DVD Player Connector Panel

connector panel may vary from actual product

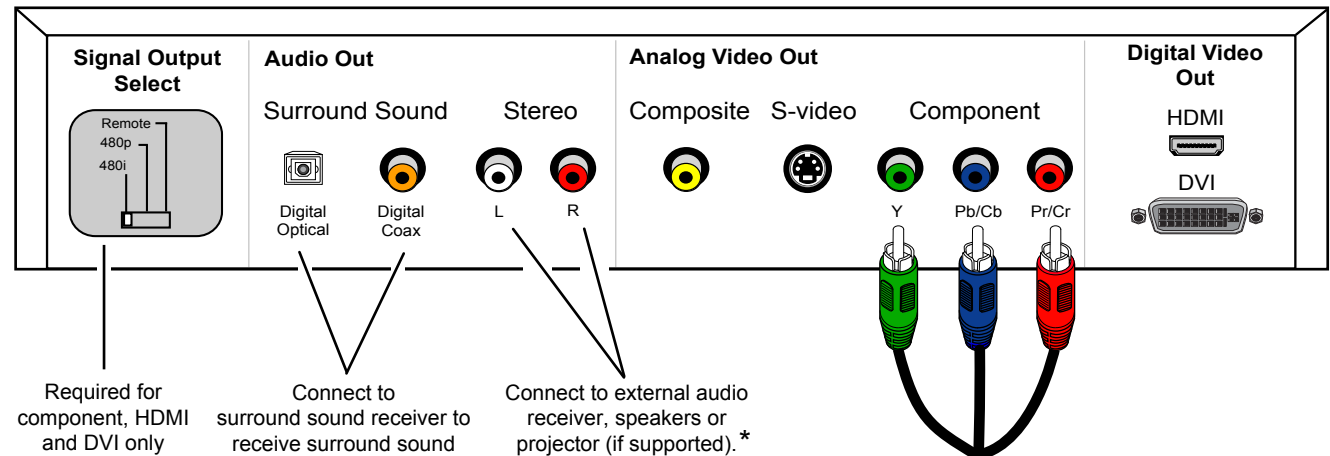

Projector Connector Panel

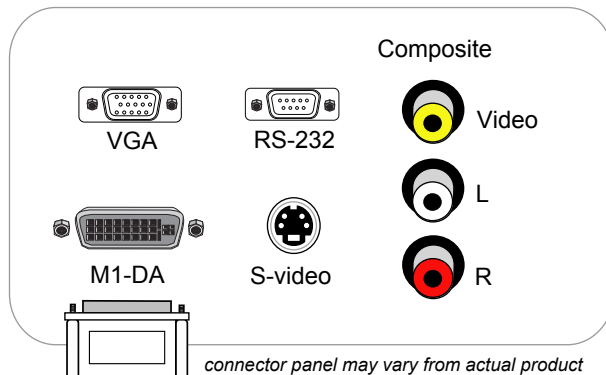

M1 to Component adapter (InFocus optional accessory)

Component video cable (optional accessory)

* We recommend connecting the DVD player to an external sound system to provide the best audio experience.

How to connect a DVD player to a projector using a DVI (digital video interface) cable

Setup Requirements

- DVD Player with DVI-out port
- Projector with M1 port and HDCP support
- M1 to DVI cable (6 ft, InFocus part #SP-DVI-D)

Alternate Setups

- M1 to DVI adapter (6 in, InFocus part #SP-DVI-ADPT) and DVI-D cable (3rd party accessory)
- M1 to DVI cable (33 ft, InFocus part #SP-M1-10M)

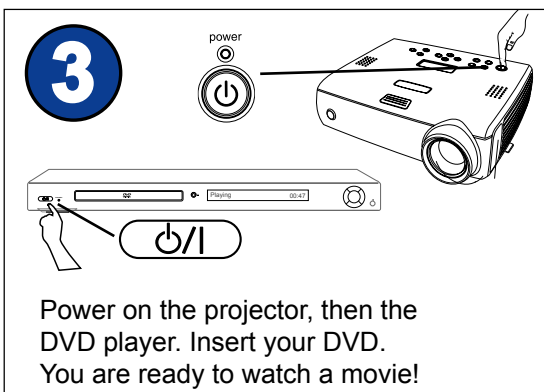
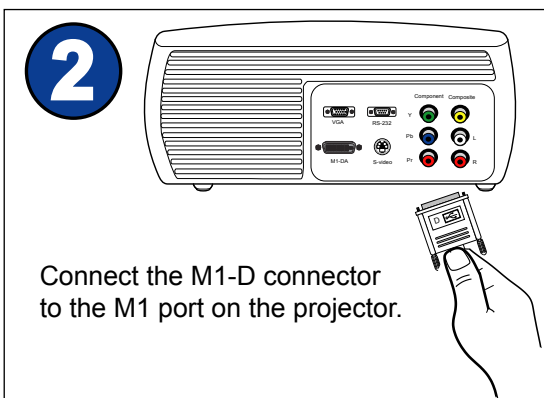
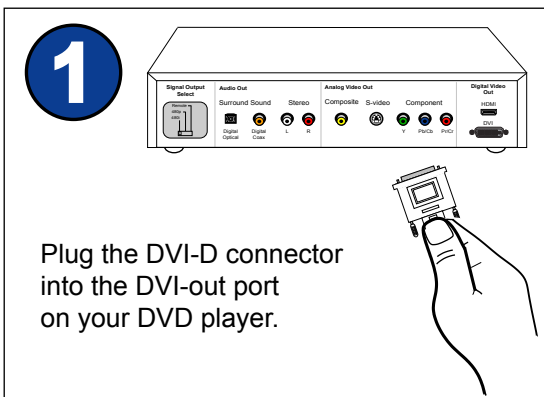

DVD Player Connector Panel

connector panel may vary from actual product

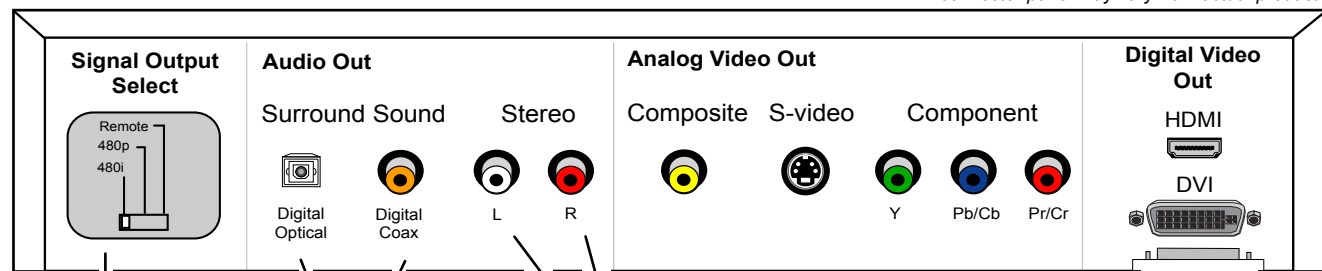

Required for component, HDMI and DVI only

Connect to surround sound receiver to receive surround sound

Connect to external audio receiver, speakers or projector (if supported).*

Do not connect

USB connector

DVI-D connector

Projector Connector Panel

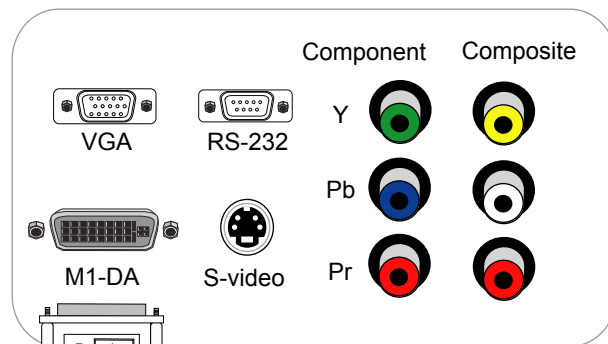

connector panel may vary from actual product

M1-D connector

M1 to DVI-D cable (6 ft) (optional accessory)



* We recommend connecting the DVD player to an external sound system to provide the best audio experience.



Setup Requirements

- DVD Player with HDMI-out port
- Projector with M1 port and HDCP support
- M1 to HDMI adapter (2 in, InFocus part#SP-HDMI-ADPT)
- HDMI cable (3rd party accessory)

1

Plug the HDMI connector into the HDMI port on your DVD player.

2

Connect the HDMI connector to the M1 to HDMI adapter on your projector. Connect the M1 to HDMI adapter to the M1-DA port on the projector.

3

Power on the projector, then the DVD player. Insert your DVD. You are ready to watch a movie!

DVD Player Connector Panel

connector panel may vary from actual product

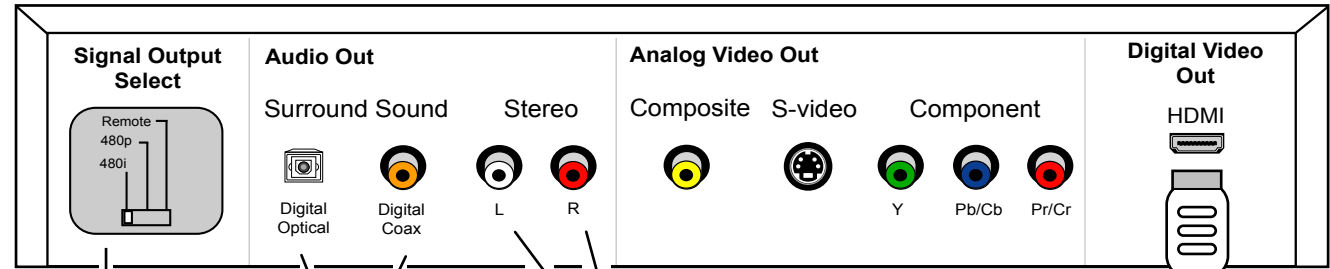

Required for component, HDMI and DVI only

Connect to surround sound receiver to receive surround sound

Connect to external audio receiver, speakers or projector (if supported).*

Projector Connector Panel

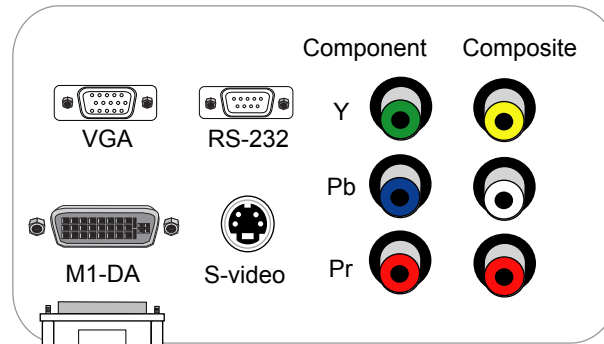

connector panel may vary from actual product

M1 to HDMI adapter (InFocus optional accessory)

HDMI cable (optional accessory)

* We recommend connecting the DVD player to an external sound system to provide the best audio experience.

Tips

- If you connect to a progressive-only input such as an M1 connector, make sure that progressive feature is enabled on the DVD player. Typically, this can be done by remote, DVD menu or a switch on the back of the DVD player. See the DVD player manual for further details.
- For the best sound, we recommend connecting the DVD player to an audio receiver or surround sound system. Only optical and coaxial audio cables support 5.1 surround sound. With RCA red and white audio cables, you only receive 2.1 stereo sound.
- Some projectors may require special adapters to receive progressive video signals. Refer to the Service and Support web site or the user guide to see the video connectivity chart for the projector.
- DVI provides the best signal. On most DVD players, your best option is to use the component connectors.
- When sending video through DVI, ensure that your projector is HDCP (high-bandwidth digital content protection) compatible. All InFocus ScreenPlay models with M1 ports are HDCP compatible. Most business projectors are not compatible. Consult the Service and Support web site or user guide. Non-HDCP projectors does not accept digital video through DVI.
- If you have a DVD player with a HDMI connection, the InFocus M1 to HDMI adapter (SP-HDMI-ADPT) is required. Third-party HDMI to DVI adapters or cables do not work with InFocus projectors.
- These settings you may find in your InFocus projector menu under Aspect Ratio. Settings may vary based on the projector model.

Native	This mode bypasses the internal scaler and displays the image with no resizing. The image may appear smaller than the screen due to the source and projector having different resolutions.
4:3	This mode resizes the image from its original format to fit a standard 4:3 aspect ratio screen. If you have a 4:3 source on a 16:9 projector, there will be black bars on the sides of the image. If you set a 16:9 movie into a 4:3 aspect ratio, this will cause the image to be vertically stretched.
16:9	This mode resizes the image to fit a widescreen 16:9 aspect ratio screen. If you have a 4:3 projector, this setting should only be used if the image proportions appear skewed with a widescreen movie. Otherwise, the image will appear horizontally stretched.
Letterbox	This mode is designed to preserve the 16:9 aspect ratio with a letterbox formatted movie by cropping top and bottom portion of the movie to fill the 16:9 screen. This setting is not intended for 16:9 formatted movies.
Natural wide	This mode stretches a 4:3 image to fit the entire 16:9 screen. The center two-thirds of the image is unchanged. The edges of the image are stretched. This is designed to have a 4:3 image fill a 16:9 screen with minimal distortion.

- Visit the Service and Support web site at <http://www.infocus.com/service> for further projector support, including FAQs, firmware, user guides and connectivity information.

Common Issues

SYMPTOMS: light bar rolling from bottom to top

Solution: This is probably a ground loop issue. Ground loop effects are caused by a differential in the power between the source and projector. The solution is to ground the source and projector. Use a ground loop isolator and/or plug both the source and projector to the same power outlet.

A rolling bar can also be caused by poorly shielded cabling. Make sure you use quality cables

SYMPTOMS: static, noise, or video artifacts in video image

Solution: Usually you can eliminate a lot of video defects by using high quality cable in as short a length as possible. For the best results, we recommend using DVI or component cables with the projector. Composite and S-video cables often result in a noisy picture. Try to keep cable length to less than 10 feet. If the setup requires a longer cable, make sure to use the thicker, well-shielded cables.

SYMPTOMS: no video image from the projector

Solution:

- Make sure the projector is searching the correct input (see the projector user's guide). If Auto Source is turned off, you need to manually change the source that the projector is searching. Press the Auto Source or Video button the projector keypad or remote.
- Try a different video cable. The cable may be defective.
- Some video ports do not accept progressive signals. Refer to connectivity chart on the Service and Support web site.

SYMPTOMS: image is not perfectly rectangular (keystoning)

Solution: When a projected image is wider at the top or the bottom (horizontal keystoning), or taller on the right or left side (vertical keystoning), the projector is not perpendicular to the screen, either in the vertical plane or the horizontal plane.

If the sides are angled, then you need to raise or lower the front of the projector. Also, most projectors have digital vertical keystone correction that you can adjust in the projector menu. If the top and bottom of the image are angled, then you need to rotate the projector left or right until the image is rectangular. Most projectors do not have digital horizontal keystone correction.

SYMPTOMS: image proportion is incorrect (i.e. people appear too tall or too short)

Solution: The aspect ratio is set incorrectly on the projector and/or the DVD player. Make sure the projector and DVD player aspect ratio are the same. In the projector menu, you can adjust the aspect ratio. In the DVD player menu, you can adjust the aspect ratio.

SYMPTOMS: sound is too soft from projector speakers

Solution: We recommend connecting the DVD audio to a home theater audio receiver or amplifier to receive a more robust and quality audio experience. The speakers on the projector are meant for very small spaces.

Frequently Asked Questions

Which one is better: 480i (480 lines interlaced) or 480p (480 lines progressive)?

Most people cannot tell the difference between 480i and 480p. It depends on whether the projector or the source has the better deinterlacer chip. When you send 480i to the projector, the projector's deinterlacer converts the signal to a progressive signal. When you send 480p, the video source's deinterlacer converts the signal. We recommend sending 480i to the projector.

Which cable provides me with the best video quality?

Connector Type	Quality	Signal Type
Composite	Good	Analog, standard definition
S-video	Better	Analog, standard definition
Component	Best	Analog, 480i, 480p, 720p, 1080i
DVI (digital video interface)	Premium	Digital, 480p, 720p, 1080i, 1080p
HDMI (high definition multimedia interface)	Premium	Digital, 480p, 720p, 1080i, 1080p, up to 8 channel audio

What does Overscan do?

Some video devices cause noise around the edges of an image. Overscan crops approximately 3% of the image to hide this video noise. The disadvantage of this feature is that you lose part of the image. Most InFocus projectors include this option in the menu when a standard definition or interlaced signal is projected. You can turn Overscan off through the projector menu or, with some projectors, with the remote control.

Where is the luma detail, chroma detail, CCS and noise reduction settings in the advanced menu? My advanced menu is not matching what I see in the user guide.

These range of advanced options varies, depending on which video source is active. The ones listed above are available only when composite, s-video or 480i component signals are projected. If you are sending digital, 480p, 720p or 1080i signals, these options are not available.

At what cable length do I lose video quality?

The answer depends on the quality of cabling you use. Some cables begin to lose noticeable quality beyond 10 feet. Higher quality cables can maintain a clean signal beyond 25 feet. To guarantee the best video quality, we recommend using heavy duty shielded cabling (for example Monster Cable or Belkin). Use as short a cable as your setup allows.

Will it help if I use a scaler or DVD player with a built-in scaler to convert my DVD signal to 720p or 1080i?

It depends on the quality of scaler. Most DVDs are recorded in 720x480, which means you will need to modify and scale the signal to 720p or 1080i. Typically, when you modify the signal, this can result in decreased video quality. With a high end scaler, you may receive better video quality.

When is the projector's deinterlacer used?

The projector's deinterlacer is used when you send an interlaced signal to the projector. If you send composite, S-video or 480i component video to the projector, the deinterlacer is used. If you send progressive, the source device's deinterlacer would be used.